

**NOTES:**

1. THIS PLAN ONLY INDICATES AREA OF FILL OF WHICH THE DEVELOPER AND ITS AGENTS ARE AWARE. IT HAS NOT BEEN CHECKED BY THE DEVELOPER, AND THE DEVELOPER DOES NOT GUARANTEE ITS ACCURACY. IN NO WAY SHOULD THIS PLAN BE READ AS A CONCLUSIVE STATEMENT OF THE FULL EXTENT OF THE FILL THAT MAY BE FOUND ON THE WHOLE LAND DEPICTED. LESSEES AND PURCHASERS SHOULD MAKE THEIR OWN INQUIRIES IN REGARD TO THE EXACT DRAINAGE, GEOTECHNICAL AND FILL CONDITIONS AFFECTING THEIR BLOCKS.
2. STREET TREES, STREET LIGHTS AND SUBSTATION LOCATIONS ARE INDICATIVE ONLY.
3. LANDSCAPING WITHIN THE INNER PROTECTION AREA MUST COMPLY WITH CLAUSE 3.7 OF THE NSW RURAL FIRE SERVICE PLANNING FOR BUSHFIRE PROTECTION (2018).

**LEGEND**

- STAGE 1B1 BOUNDARY: [Blue dashed line]
- FINISHED SURFACE CONTOURS (1m): [Grey line]
- FILL: [Green shaded area]
- FILL DEPTH (to nearest 100mm): [Green gradient]
- STREETLIGHT: [Orange star symbol]
- STREET TREE: [Green circle symbol]
- DRIVEWAY LOCATION: [Brown rectangle symbol]
- SUBSTATION (ELECTRICAL): [Orange square symbol]
- BLOCK AREA / BOUNDARY LENGTH: [400m² 4.54]
- 3.0m COMBINED EASEMENT (Sewer and Stormwater): [Dashed line]
- PATH (1.2 - 2.5m wide): [Grey line]
- BUSHFIRE ATTACK LEVEL: [BAL 12.5]
- INNER PROTECTION AREA AFFECTED BLOCK (refer note 3): [Red circle symbol]
- ONE WAY TRAFFIC DIRECTION: [Arrow symbol]
- TACTILE AND AUDIBLE SURFACE TREATMENT: [Hatched area symbol]

file name: 306356CS023.dwg  
 file location: G:\306356\306356\Civil\ACAD\Superplans\Sales Plans\plot\_date\_12/07/2021\_1:42 PM\_Sheet 1 of 28\_Sheets

Rev	Amendments	Approved	Date
D	DRIVEWAYS UPDATED	BC	12-07-21
C	FILL ON BLOCK UPDATED	BC	15-03-21
B	FILL ON BLOCK UPDATED FOR REVISED 1B GRADING	BC	21-09-20
A	FIRST ISSUE	BC	30-07-20

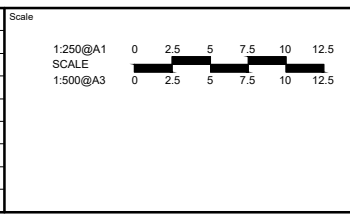

© Spiire Australia Pty Ltd All Rights Reserved  
 This document is produced by Spiire Australia Pty Ltd solely for the benefit of and use by the client in accordance with the terms of the retainer. Spiire Australia Pty Ltd does not and shall not assume any responsibility or liability whatsoever to any third party arising out of any use or reliance by third party on the content of this document.

Lvl 1, 243 Northbourne Ave Lyneham  
 Australian Capital Territory Australia T 61 2 6102 1000  
 spiire.com.au ABN 55 050 029 635

Designed: [ ] Checked: [ ]  
 Authorised: [ ] Date: [ ]

**SOUTH JERRABOMBERRA SALES PLAN**  
 STAGE 1B1  
 SHEET 23 - SECTION AJ  
 QPRC  
 VILLAGE BUILDING COMPANY

Rev No: 306356CS023 Rev: D

file name: 306356CS024.dwg layout name: CS024 plotted by: Danielle Fotigki file location: G:\306356\306356\Civil\ACAD\Superlots Sales Plans plot date: 12/07/2021 1:43 PM Sheet 2 of 28 Sheets

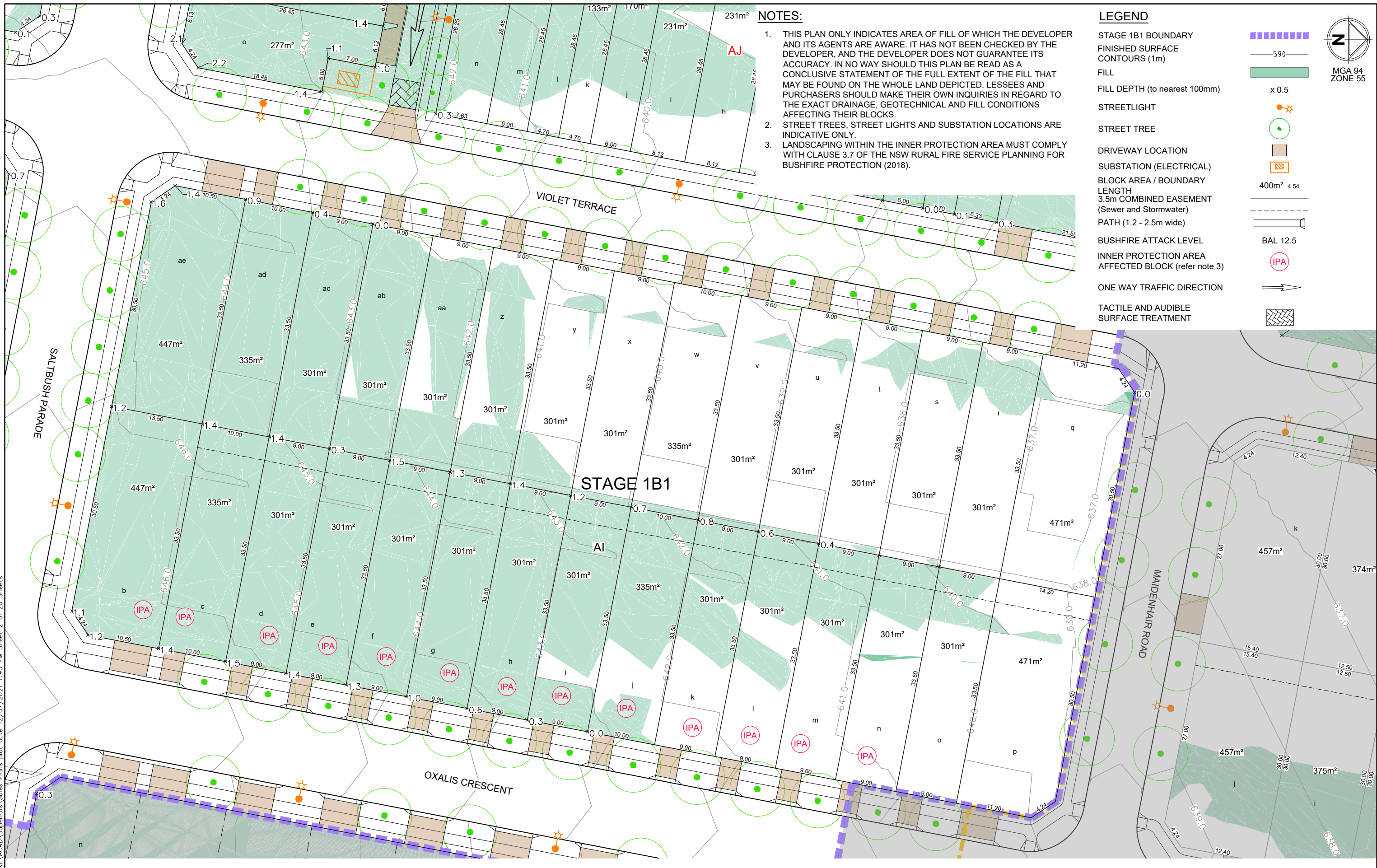

**NOTES:**

1. THIS PLAN ONLY INDICATES AREA OF FILL OF WHICH THE DEVELOPER AND ITS AGENTS ARE AWARE. IT HAS NOT BEEN CHECKED BY THE DEVELOPER, AND THE DEVELOPER DOES NOT GUARANTEE ITS ACCURACY. IN NO WAY SHOULD THIS PLAN BE READ AS A CONCLUSIVE STATEMENT OF THE FULL EXTENT OF THE FILL THAT MAY BE FOUND ON THE WHOLE LAND DEPICTED. LESSEES AND PURCHASERS SHOULD MAKE THEIR OWN INQUIRIES IN REGARD TO THE EXACT DRAINAGE, GEOTECHNICAL AND FILL CONDITIONS AFFECTING THEIR BLOCKS.
2. STREET TREES, STREET LIGHTS AND SUBSTATION LOCATIONS ARE INDICATIVE ONLY.
3. LANDSCAPING WITHIN THE INNER PROTECTION AREA MUST COMPLY WITH CLAUSE 3.7 OF THE NSW RURAL FIRE SERVICE PLANNING FOR BUSHFIRE PROTECTION (2018).

**LEGEND**

- STAGE 1B1 BOUNDARY: [Blue dashed line]
- FINISHED SURFACE CONTOURS (1m): [Grey line with '590']
- FILL: [Green shaded area]
- FILL DEPTH (to nearest 100mm): [Green shaded area with 'x 0.5']
- STREETLIGHT: [Orange star symbol]
- STREET TREE: [Green circle with star]
- DRIVEWAY LOCATION: [Brown rectangle]
- SUBSTATION (ELECTRICAL): [Orange square with 'S']
- BLOCK AREA / BOUNDARY LENGTH: [400m² 4.54]
- 3.5m COMBINED EASEMENT (Sewer and Stormwater): [Dashed line]
- PATH (1.2 - 2.5m wide): [Grey line]
- BUSHFIRE ATTACK LEVEL: [BAL 12.5]
- INNER PROTECTION AREA: [Red circle with 'IPA']
- AFFECTED BLOCK (refer note 3): [Red circle with 'IPA']
- ONE WAY TRAFFIC DIRECTION: [Arrow]
- TACTILE AND AUDIBLE SURFACE TREATMENT: [Hatched pattern]



Rev	Amendments	Approved	Date
D	FILL ON BLOCKS UPDATED	BC	15-03-21
C	IPA CORRECTED FOR SECTION A1	BC	06-10-2020
B	FILL ON BLOCK UPDATED FOR REVISED 1B GRADING	BC	21-09-20
A	FIRST ISSUE	BC	30-07-20

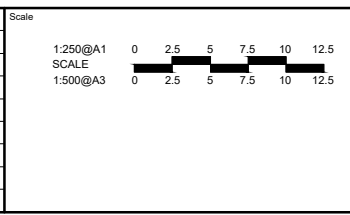

**spiire**  
 Lvl 1, 243 Northbourne Ave Lyneham  
 Australian Capital Territory Australia T 61 2 6102 1000  
 spiire.com.au ABN 55 050 029 635

**Village**  
 Designed: [ ] Checked: [ ]  
 Authorised: [ ] Date: [ ]

**SOUTH JERRABOMBERRA SALES PLAN**  
 STAGE 1B1  
 SHEET 24 - SECTION A1  
 QPRC  
 VILLAGE BUILDING COMPANY  
 Drg No: 306356CS024 Rev: D

file name: 306356CS023.dwg  
 layout name: CS025  
 plotted by: Danielle Fotigki  
 file location: G:\306356\ACAD\Superlots Sales Plans plot\_date: 12/07/2021 1:43 PM Sheet 3 of 28 Sheets

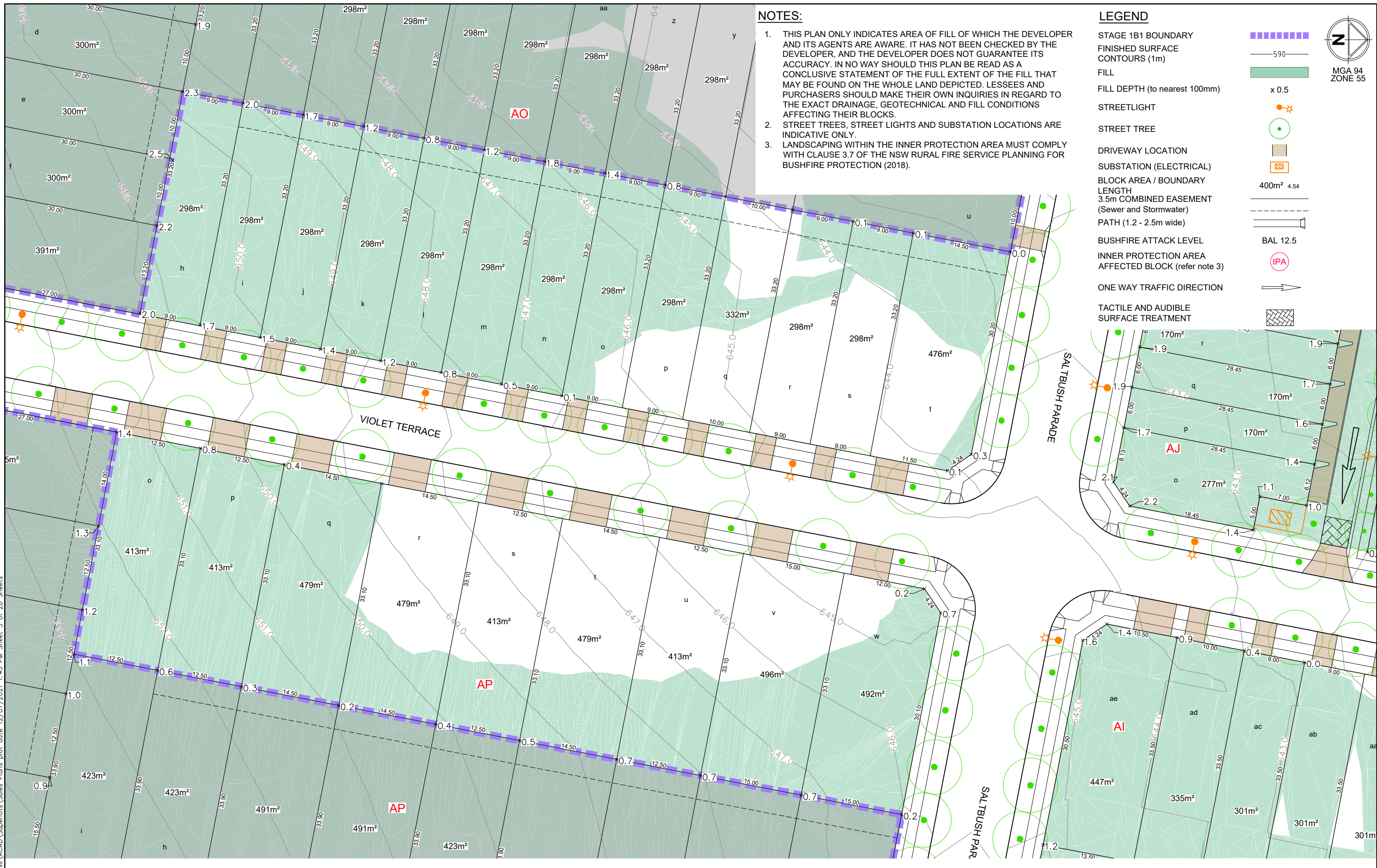

**NOTES:**

1. THIS PLAN ONLY INDICATES AREA OF FILL OF WHICH THE DEVELOPER AND ITS AGENTS ARE AWARE. IT HAS NOT BEEN CHECKED BY THE DEVELOPER, AND THE DEVELOPER DOES NOT GUARANTEE ITS ACCURACY. IN NO WAY SHOULD THIS PLAN BE READ AS A CONCLUSIVE STATEMENT OF THE FULL EXTENT OF THE FILL THAT MAY BE FOUND ON THE WHOLE LAND DEPICTED. LESSEES AND PURCHASERS SHOULD MAKE THEIR OWN INQUIRIES IN REGARD TO THE EXACT DRAINAGE, GEOTECHNICAL AND FILL CONDITIONS AFFECTING THEIR BLOCKS.
2. STREET TREES, STREET LIGHTS AND SUBSTATION LOCATIONS ARE INDICATIVE ONLY.
3. LANDSCAPING WITHIN THE INNER PROTECTION AREA MUST COMPLY WITH CLAUSE 3.7 OF THE NSW RURAL FIRE SERVICE PLANNING FOR BUSHFIRE PROTECTION (2018).

**LEGEND**

STAGE 1B1 BOUNDARY	
FINISHED SURFACE CONTOURS (1m)	
FILL	
FILL DEPTH (to nearest 100mm)	x 0.5
STREETLIGHT	
STREET TREE	
DRIVEWAY LOCATION	
SUBSTATION (ELECTRICAL)	
BLOCK AREA / BOUNDARY LENGTH	400m <sup>2</sup> 4.54
3.5m COMBINED EASEMENT (Sewer and Stormwater)	
PATH (1.2 - 2.5m wide)	
BUSHFIRE ATTACK LEVEL	BAL 12.5
INNER PROTECTION AREA	
AFFECTED BLOCK (refer note 3)	
ONE WAY TRAFFIC DIRECTION	
TACTILE AND AUDIBLE SURFACE TREATMENT	



Rev	Amendments	Approved	Date
C	FILL ON BLOCK UPDATED	BC	15-03-21
B	FILL ON BLOCK UPDATED FOR REVISED 1B GRADING	BC	21-09-20
A	FIRST ISSUE	BC	30-07-20

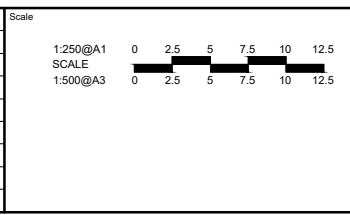

**spiire**

Lvl 1, 243 Northbourne Ave Lyneham  
 Australian Capital Territory Australia T 61 2 6102 1000  
 spiire.com.au ABN 55 050 029 635

**Village**

Designed \_\_\_\_\_ Checked \_\_\_\_\_  
 Authorised \_\_\_\_\_ Date \_\_\_\_\_

**SOUTH JERRABOMBERRA SALES PLAN**  
 STAGE 1B1  
 SHEET 25 - SECTION AP & AO  
 QPRC  
 VILLAGE BUILDING COMPANY

Rev No: 306356CS025 Rev: C