

NOTES:

1. THIS PLAN ONLY INDICATES AREA OF FILL OF WHICH THE DEVELOPER AND ITS AGENTS ARE AWARE. IT HAS NOT BEEN CHECKED BY THE DEVELOPER, AND THE DEVELOPER DOES NOT GUARANTEE ITS ACCURACY. IN NO WAY SHOULD THIS PLAN BE READ AS A CONCLUSIVE STATEMENT OF THE FULL EXTENT OF THE FILL THAT MAY BE FOUND ON THE WHOLE LAND DEPICTED. LESSEES AND PURCHASERS SHOULD MAKE THEIR OWN INQUIRIES IN REGARD TO THE EXACT DRAINAGE, GEOTECHNICAL AND FILL CONDITIONS AFFECTING THEIR BLOCKS.
2. STREET TREES, STREET LIGHTS AND SUBSTATION LOCATIONS ARE INDICATIVE ONLY.
3. LANDSCAPING WITHIN THE INNER PROTECTION AREA MUST COMPLY WITH CLAUSE 3.7 OF THE NSW RURAL FIRE SERVICE PLANNING FOR BUSHFIRE PROTECTION (2018).

LEGEND

- STAGE 1A BOUNDARY
- FINISHED SURFACE CONTOURS (1m)
- FILL
- FILL DEPTH (to nearest 100mm)
- STREETLIGHT
- STREET TREE
- DRIVEWAY LOCATION
- SUBSTATION
- BLOCK AREA / BOUNDARY LENGTH
- 3.0m COMBINED EASEMENT (Sewer and Stormwater)
- PATH (1.2 - 2.5m wide)
- BUSHFIRE ATTACK LEVEL
- INNER PROTECTION AREA AFFECTED BLOCK (refer note 3)
- ONE WAY TRAFFIC DIRECTION
- TACTILE AND AUDIBLE SURFACE TREATMENT



file name: 306356CS020.dwg, layout name: CS020, plotted by: Tom Willburger, file location: G:\30\306356\306356\Civil\CAD\Superior\Sales Plans\plot date 03/05/2021 1:28 PM Sheet 22 of 28 Sheets

| | | | | | | |
|----------|---|-----|---|-----|----|------|
| 1:250@A1 | 0 | 2.5 | 5 | 7.5 | 10 | 12.5 |
| 1:500@A3 | 0 | 2.5 | 5 | 7.5 | 10 | 12.5 |

| | | | |
|-----|--------------------------------|----------|------------|
| B | BACKGROUND INFORMATION UPDATED | BC | 03-05-21 |
| A | FIRST ISSUE | BC | 25-03-2020 |
| Rev | Amendments | Approved | Date |

© Spiire Australia Pty Ltd All Rights Reserved
 This document is produced by Spiire Australia Pty Ltd solely for the benefit of and use by the client in accordance with the terms of the retainer. Spiire Australia Pty Ltd does not and shall not assume any responsibility or liability whatsoever to any third party arising out of any use or reliance by third party on the contents of this document.

Lvl 1, 243 Northbourne Ave Lyneham
 Australian Capital Territory Australia T 61 2 6102 1000
 spiire.com.au ABN 55 050 029 635

Designed _____ Checked _____
 Authorised _____ Date _____

SOUTH JERRABOMBERRA SALES PLAN
STAGE 1A
SHEET 20 - SECTION AK
 QPRC
 VILLAGE BUILDING COMPANY

Drg No **306356CS020** Rev **B**

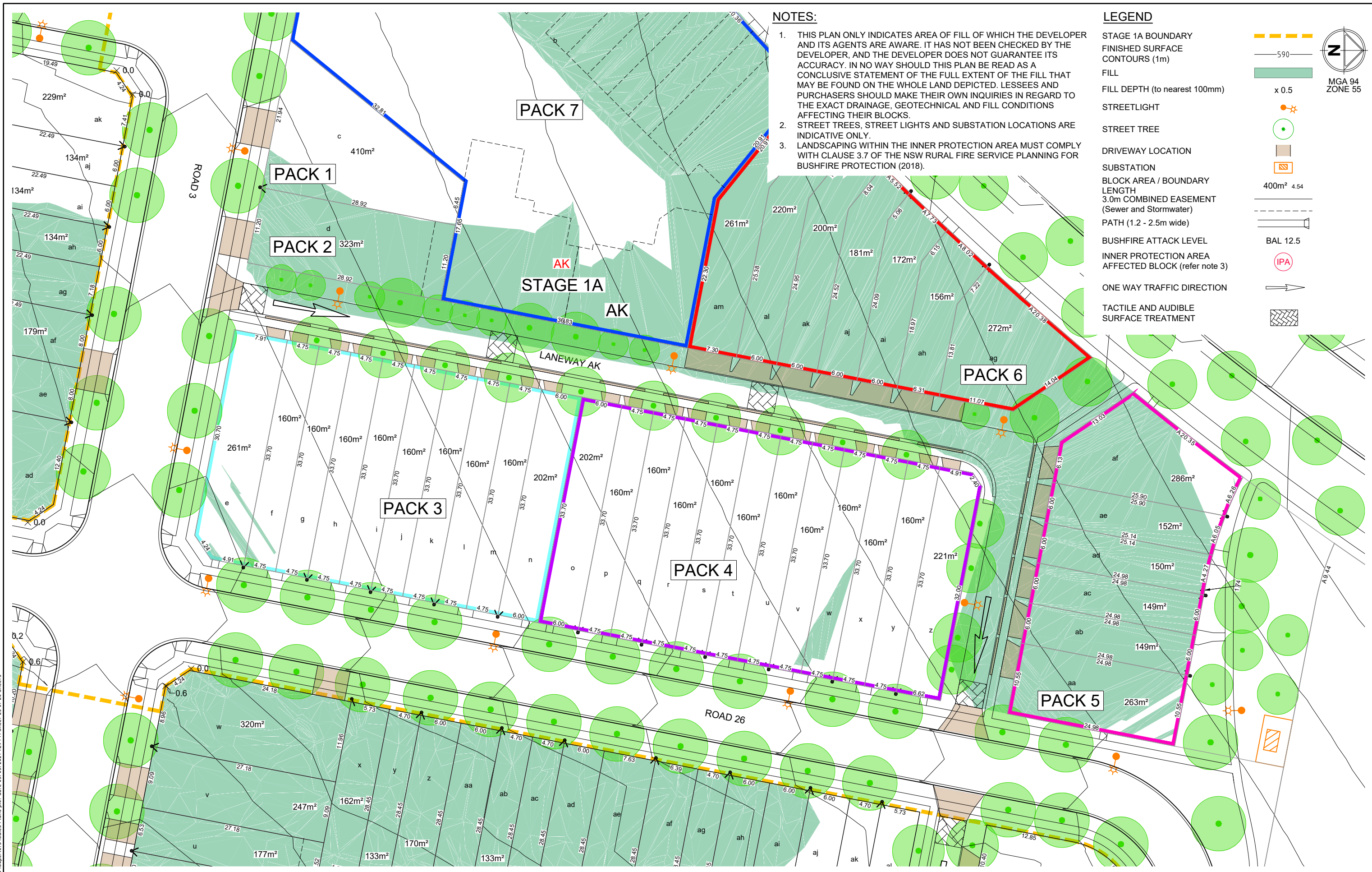

NOTES:

1. THIS PLAN ONLY INDICATES AREA OF FILL OF WHICH THE DEVELOPER AND ITS AGENTS ARE AWARE. IT HAS NOT BEEN CHECKED BY THE DEVELOPER, AND THE DEVELOPER DOES NOT GUARANTEE ITS ACCURACY. IN NO WAY SHOULD THIS PLAN BE READ AS A CONCLUSIVE STATEMENT OF THE FULL EXTENT OF THE FILL THAT MAY BE FOUND ON THE WHOLE LAND DEPICTED. LESSEES AND PURCHASERS SHOULD MAKE THEIR OWN INQUIRIES IN REGARD TO THE EXACT DRAINAGE, GEOTECHNICAL AND FILL CONDITIONS AFFECTING THEIR BLOCKS.
2. STREET TREES, STREET LIGHTS AND SUBSTATION LOCATIONS ARE INDICATIVE ONLY.
3. LANDSCAPING WITHIN THE INNER PROTECTION AREA MUST COMPLY WITH CLAUSE 3.7 OF THE NSW RURAL FIRE SERVICE PLANNING FOR BUSHFIRE PROTECTION (2018).

LEGEND

- STAGE 1A BOUNDARY (Yellow dashed line)
- FINISHED SURFACE CONTOURS (1m) (Grey line with '590')
- FILL (Green shaded area)
- FILL DEPTH (to nearest 100mm) (x 0.5)
- STREETLIGHT (Orange star symbol)
- STREET TREE (Green circle with dot)
- DRIVEWAY LOCATION (Brown rectangle)
- SUBSTATION (Orange square with 'S')
- BLOCK AREA / BOUNDARY LENGTH (400m² 4.54)
- 3.0m COMBINED EASEMENT (Sewer and Stormwater) (Dashed line)
- PATH (1.2 - 2.5m wide) (Grey line)
- BUSHFIRE ATTACK LEVEL (BAL 12.5)
- INNER PROTECTION AREA AFFECTED BLOCK (refer note 3) (Red circle with 'IPA')
- ONE WAY TRAFFIC DIRECTION (Arrow)
- TACTILE AND AUDIBLE SURFACE TREATMENT (Hatched pattern)



file name: 306356CS020.dwg, layout name: CS021, plotted by: Tom Willburger, file location: G:\30\306356\306356\Civil\CAD\Superior\Sales Plans\plot date 03/05/2021 1:29 PM Sheet 23 of 28 Sheets

| | | | |
|-----|--------------------------------|----------|------------|
| Rev | Amendments | Approved | Date |
| B | BACKGROUND INFORMATION UPDATED | BC | 03-05-21 |
| A | FIRST ISSUE | BC | 25-03-2020 |

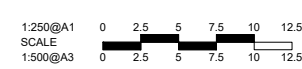

© Spiire Australia Pty Ltd All Rights Reserved
 This document is produced by Spiire Australia Pty Ltd solely for the benefit of and use by the client in accordance with the terms of the retainer. Spiire Australia Pty Ltd does not and shall not assume any responsibility or liability whatsoever to any third party arising out of any use or reliance by third party on the contents of this document.

Lvl 1, 243 Northbourne Ave Lyneham
 Australian Capital Territory Australia T 61 2 6102 1000
 spiire.com.au ABN 55 050 029 635

Designed: _____ Checked: _____
 Authorised: _____ Date: _____

SOUTH JERRABOMBERRA SALES PLAN
 STAGE 1A
 SHEET 21 - SECTION AK
 QPRC
 VILLAGE BUILDING COMPANY

Drg No: **306356CS021** Rev: **B**