

# HOME&LAND



**SOPHIA 22M**  
**\$428,340**

House: \$236,340\* | Land: \$192,000

WOODLINKS VILLAGE | COLLINGWOOD PARK | Lot 420m<sup>2</sup> = 14 x 30 m



## CONTEMPORARY LIVING HOME INCLUSIONS

- H1 slab allowance
- Colorbond roof with sarking
- 2590mm ceilings
- Tiled slab to outdoor living
- \*Price includes June promotion of \$20,000 discount on house
- Daikin ducted reverse cycle air conditioner
- Exposed aggregate driveway, fence, turf and landscaping allowance
- Letterbox & Clothesline
- Gas hot water system & Cooktop
- Floor coverings throughout = carpets and tiles
- 900mm Stainless Steel appliances
- Caesarstone bench tops throughout including bathrooms
- LED downlights
- Upgraded Hampton façade, with front render
- NBN prewire
- \* Standard Bold home and land package conditions apply
- 20 week build time guarantee\*

OPTION



OPTION

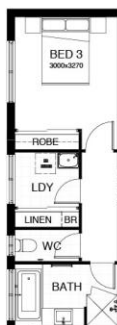

OPTION

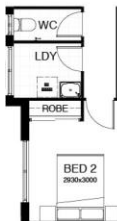

Australia's No.1 Medium Builder

CONTACT - James Meiklejohn  
 0418 486 699

[j.meiklejohn@boldliving.com.au](mailto:j.meiklejohn@boldliving.com.au)